

COMUNE DI SAN CIPIRELLO
(città metropolitana di Palermo)

ALLEGATO ALLA RICHIESTA DI AUTORIZZAZIONE UNICA
AMBIENTALE(A.U.A.), AI SENSI DEL D.Lgs 152¹⁸² e ss.mm.ii. PER LA DITTA
ARTIGIANALE ADIBITA AD AUTOLAVAGGIO, AL PIANO TERRA, DEL
FABBRICATO SITO IN VIA MAZZINI N. 90.
- FOGLIO: 1, PART.LLA:709 sub. 9 -

- DITTA : DI FALCO TOMMASO -

ELABORATO:		DATA:
- ELABORATI GRAFICI -		SCALA:
LA DITTA	IL TECNICO	TRAVOLA:
		2

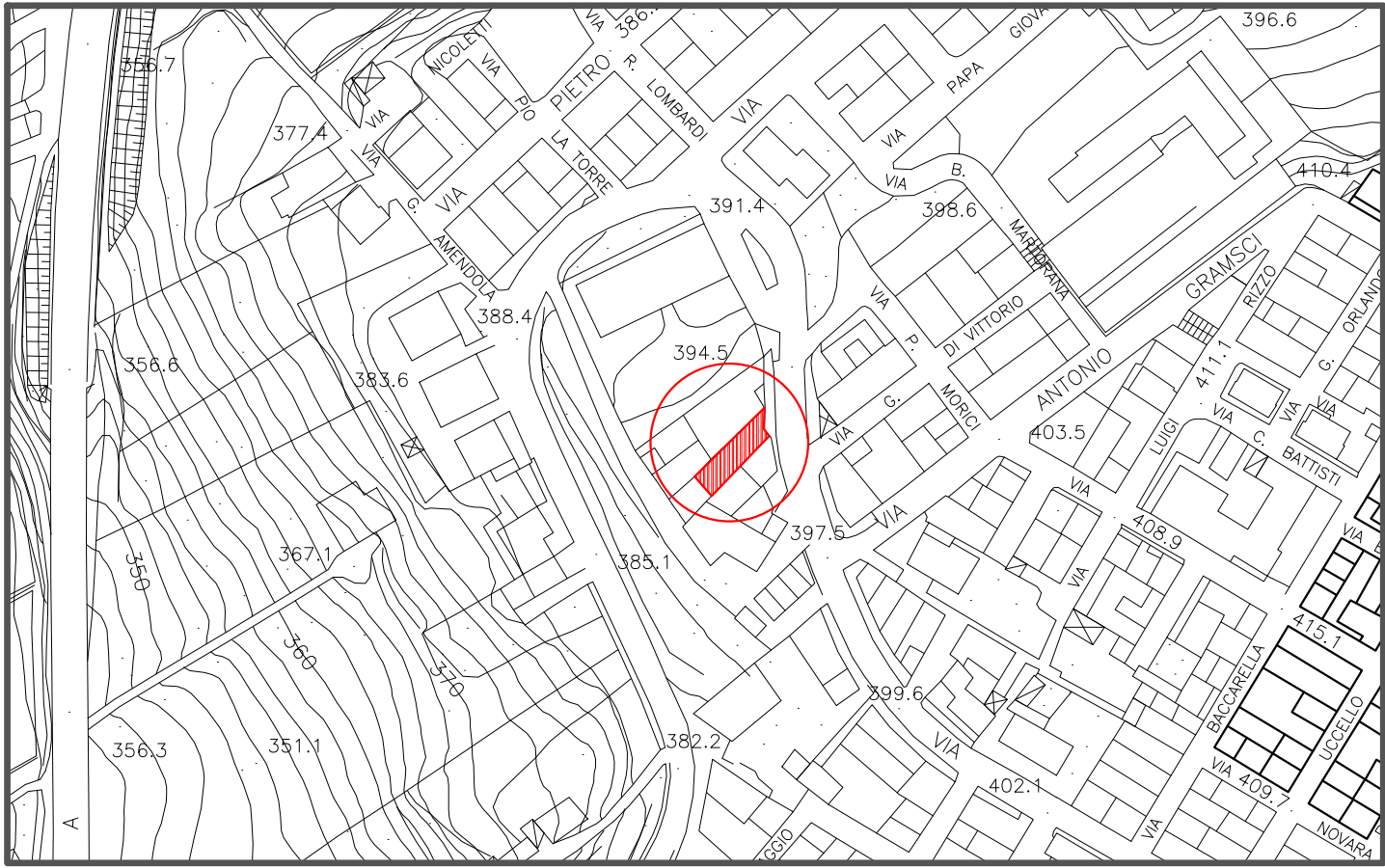

- Stralcio aereofotogrammetria Scala 1 : 2.000 -

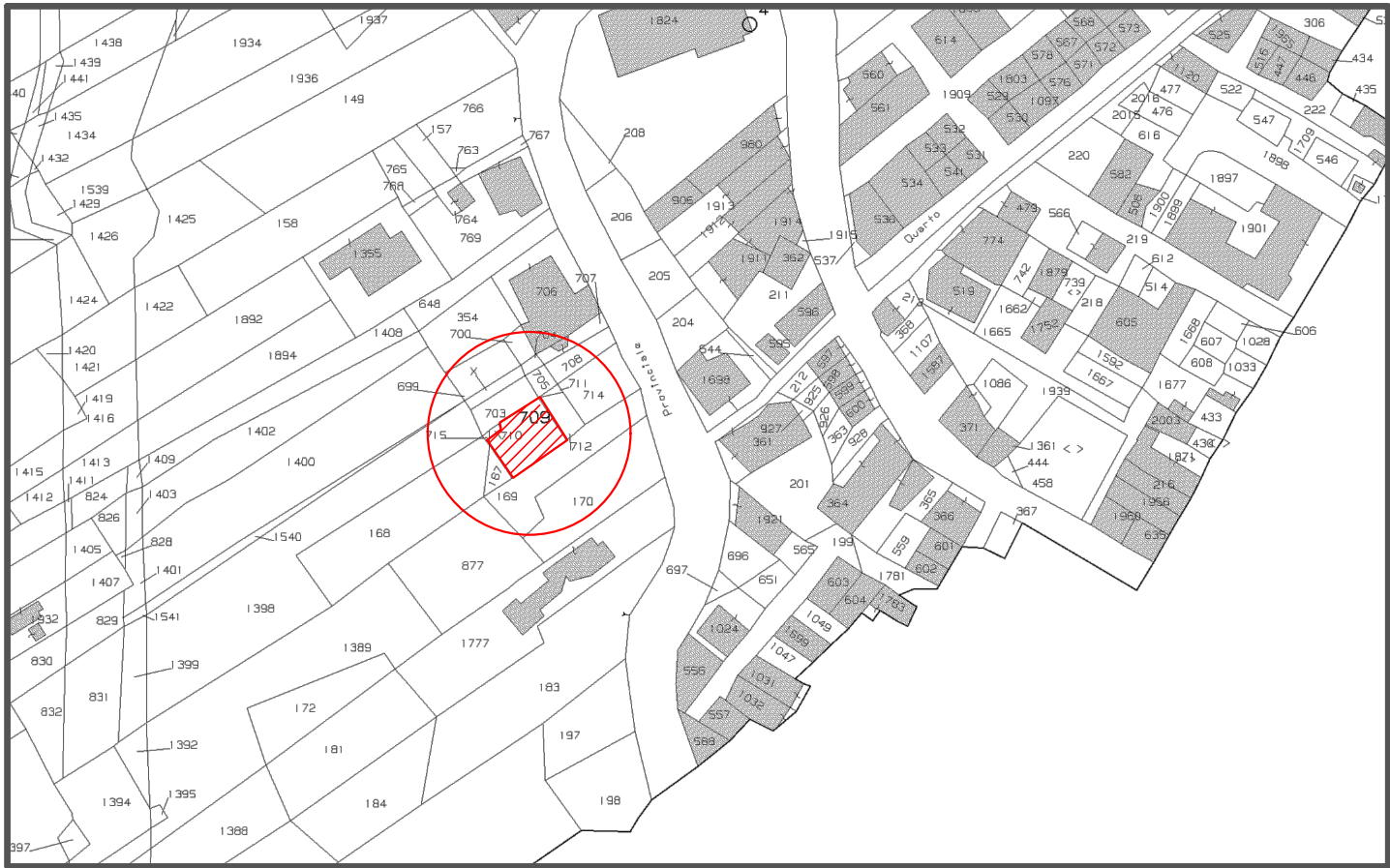

- Stralcio catastale Scala 1 : 1.000 -

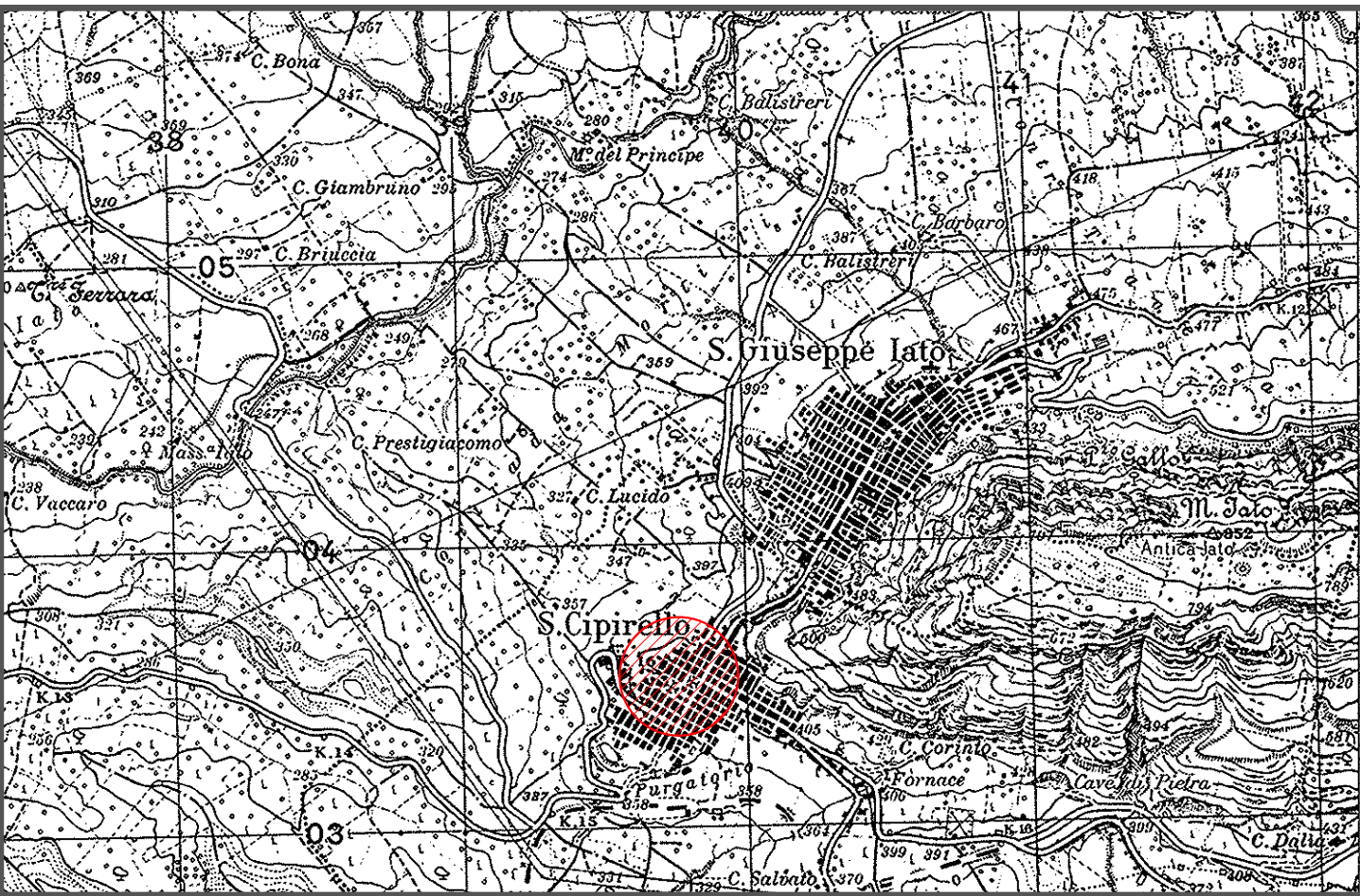

- Stralcio I.G.M. Scala 1 : 25.000 -

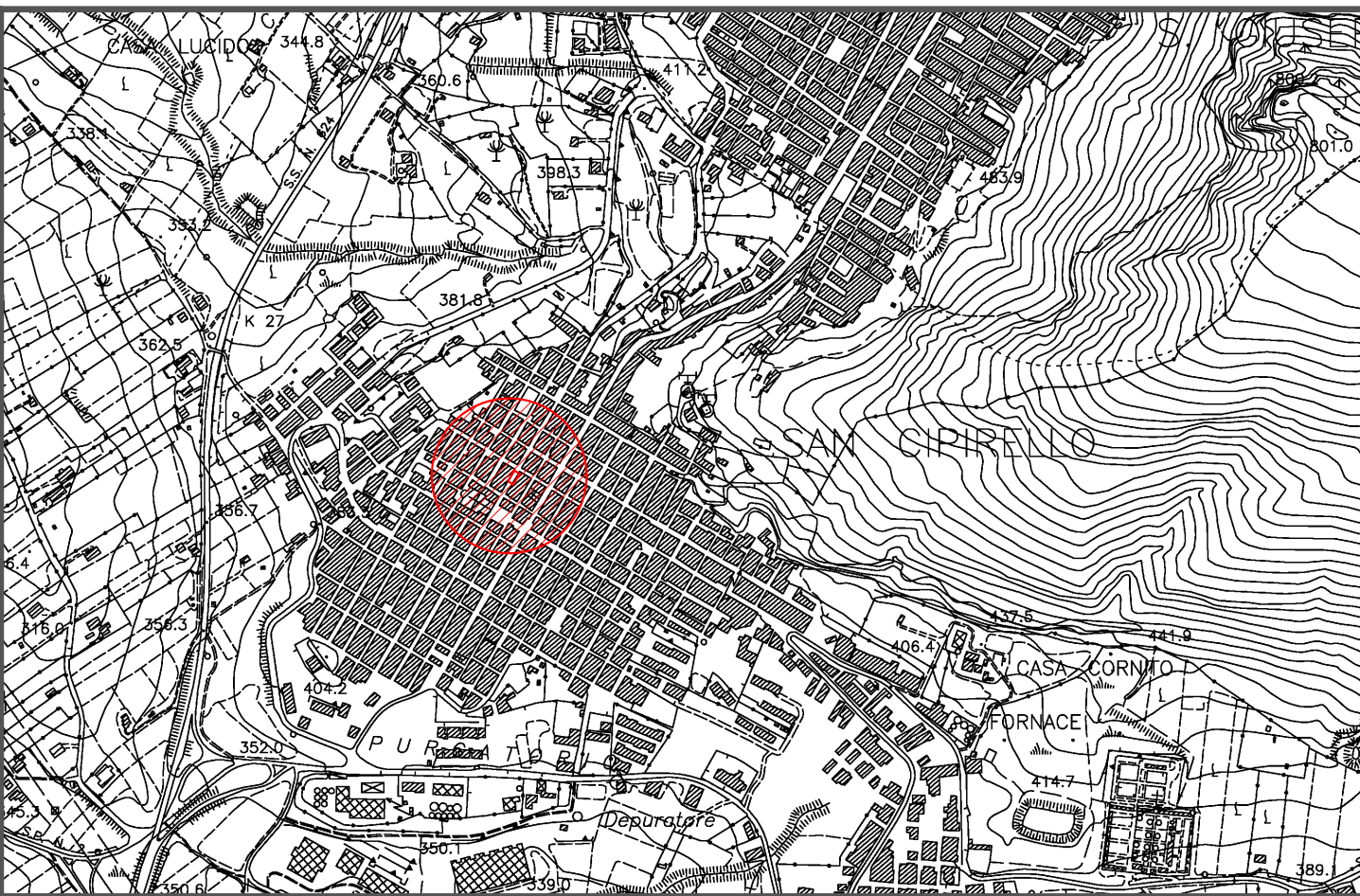

- Stralcio aereofotogrammetria Scala 1 : 10.000 -

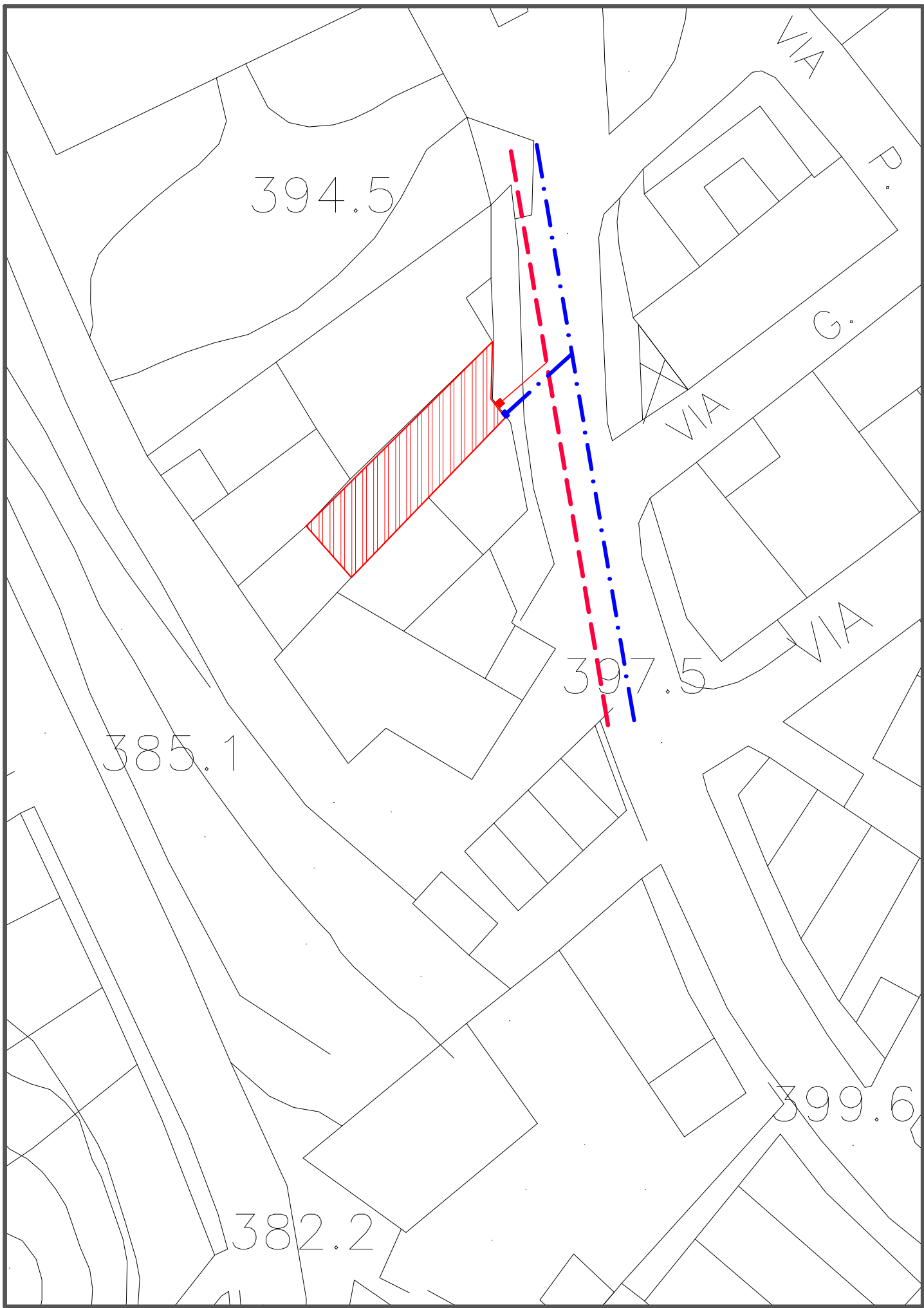

- Stralcio Planimetria Generale Scala 1 : 500 -

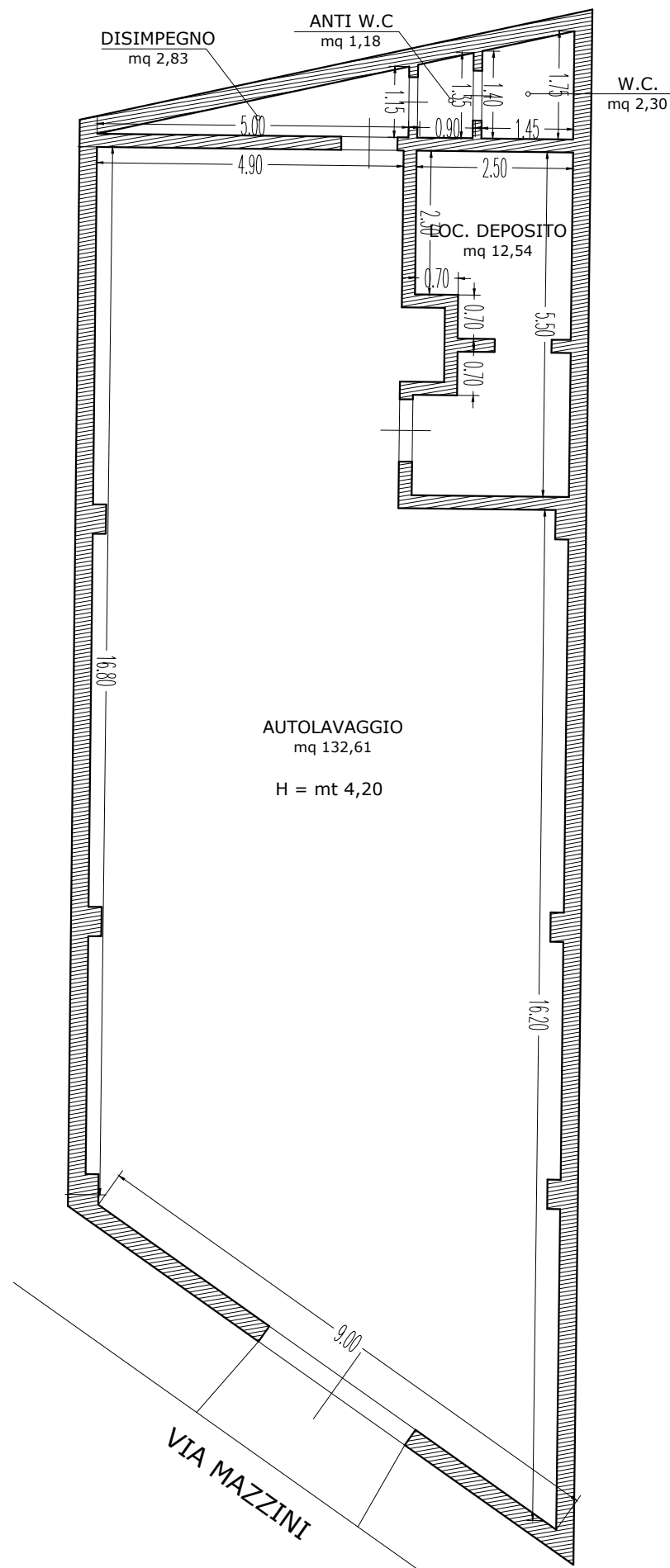

PIANTA PIANO TERRA
Scala 1 : 100

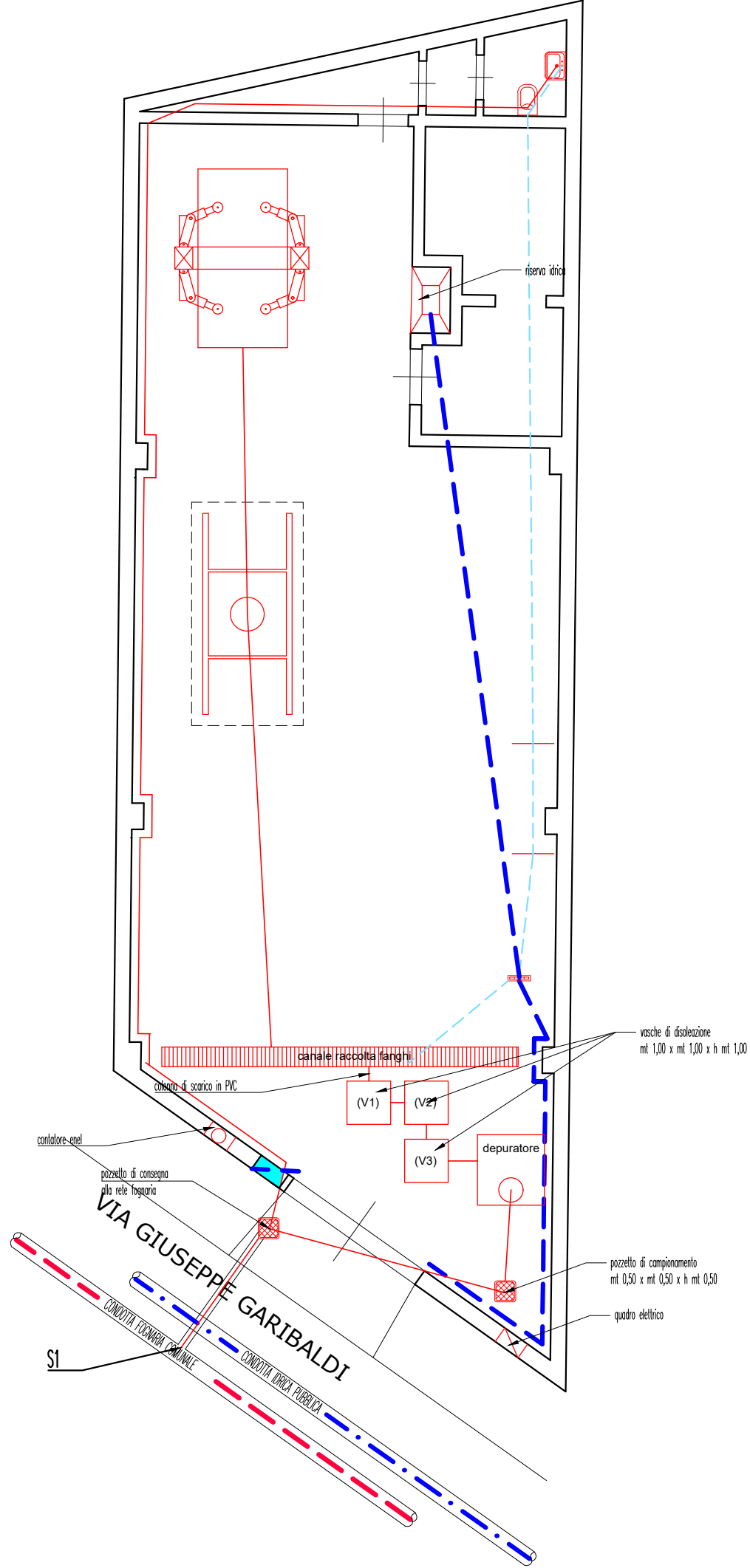

PLANIMETRIA CON RETI FOGNARIA ED IDRICA

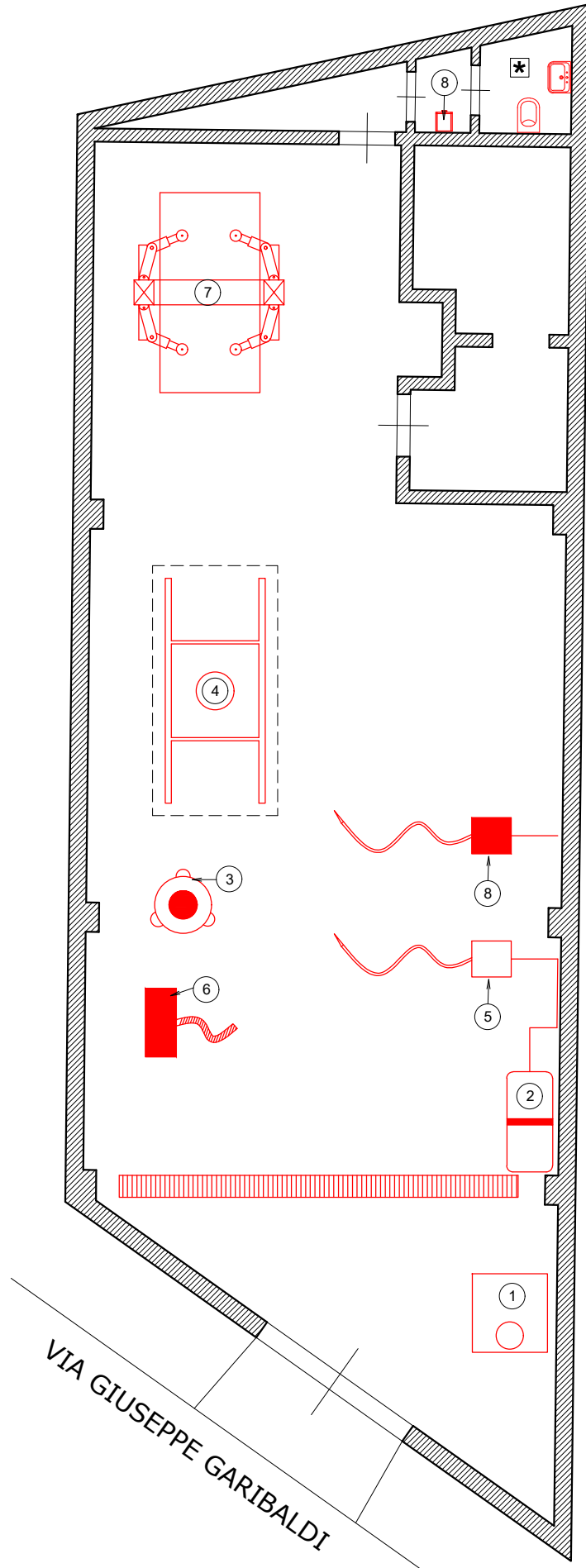

PIANTA PIANO TERRA
Scala 1 : 100

PLANIMETRIA CON ATTREZZATURE

ELENCO ATTREZZATURE	
1	Depuratore
2	Compressore FINI
3	Aspirapolvere Mec
4	Ponte idraulico a X
5	Idropultrice Novo Jet
6	Aspira liquidi Alfatec
7	Ponte a 2 colonne ZIPPO sn: 15675
8	Idropultrice Interpump Group

Ventilazione forzata

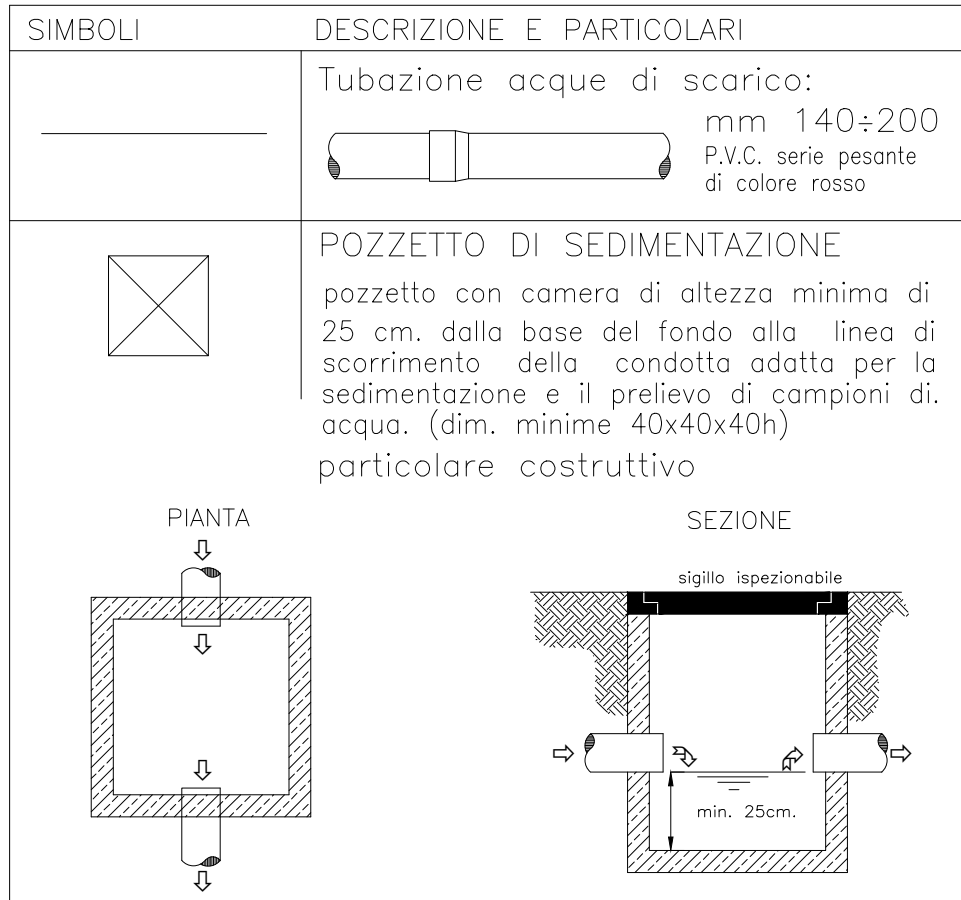

SCHEMA POZZETTO DI CONSEGNA E
PRELEVAMENTO CAMPIONI